

Help Johnny find his way out!

There are four ways Johnny can escape from the burning house. Help him CRAWL to the first escape, then continue on until he finds all four.
DO YOU HAVE A FIRE ESCAPE PLAN FOR YOUR HOUSE?

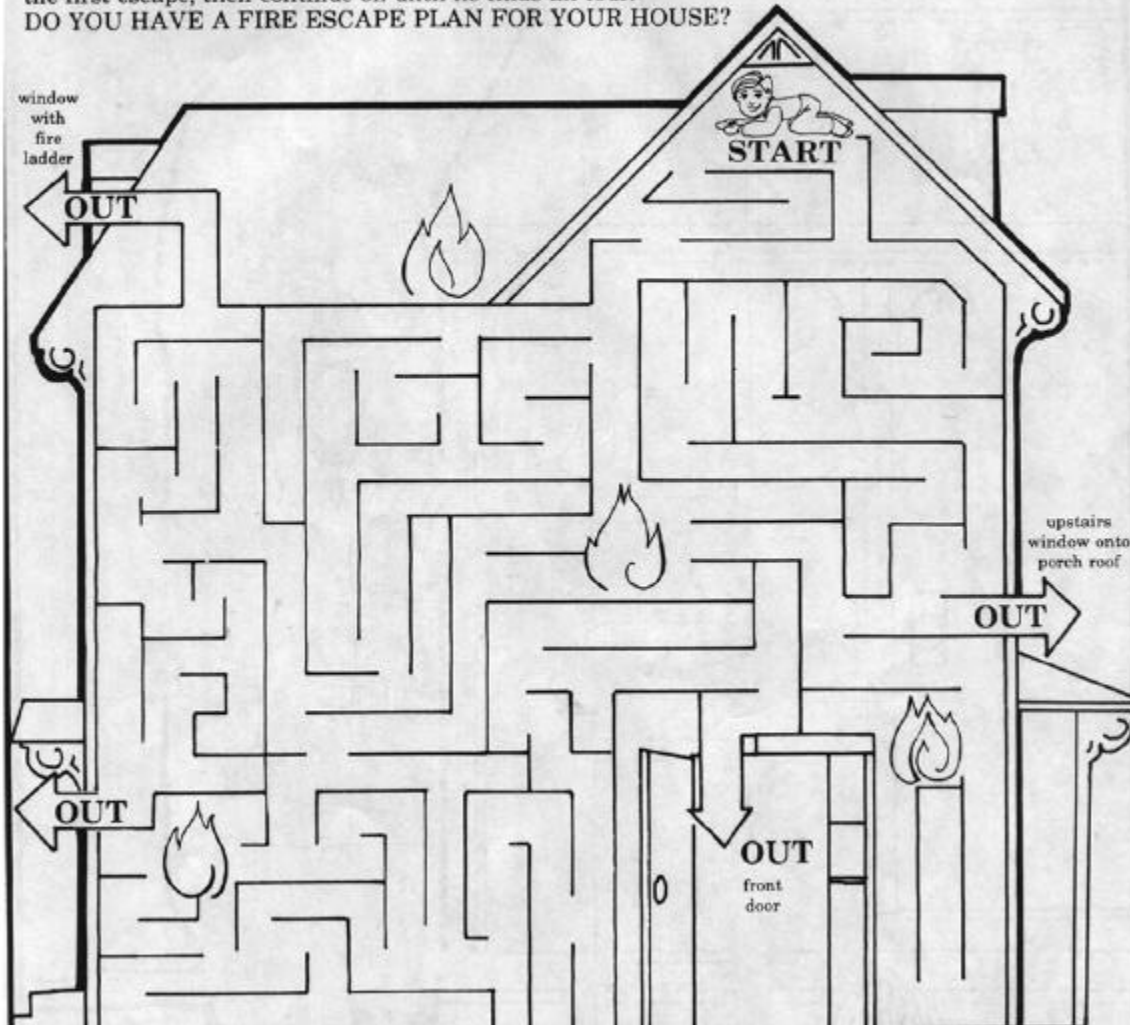

Visit MHFIRE on the WWW! <http://www.mhfire.org>

MHFIRE